

PROGETTO

AREA "EX FIAT" - VARIANTE

PIANO ATTUATIVO - PR 3D3

COMUNE DI BIBBIENA - AREZZO

TITOLO

RENDERING MODELLO

PROPRIETA'

LO.CLA.IM. SPA

loclaim@legalmail.it
PIAZZA D'AZEGLIO, 39
50129 FIRENZE
FIRENZE ITALY

PROGETTO

ROBERTO RENZETTI ARCHITETTO

roberto.renzetti@archiworldpec.it
TEL. +39 0575 56 10 69 FAX +39 0575 56 27 35
VIA GIUSEPPE BOCCI, 40
52010 SOCI
AREZZO ITALY

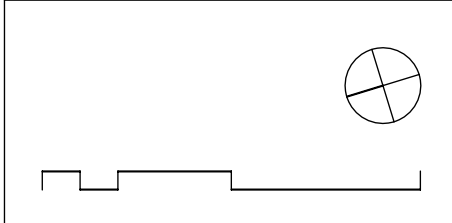

SCALA

DATA

*

02/2020 LF

COMMESSA

INFOFILE - ALLPLAN

C20002

C20002 PB44

AGGIORNAMENTI

NOTE

05/2020 LF

*

ELABORATO

R5

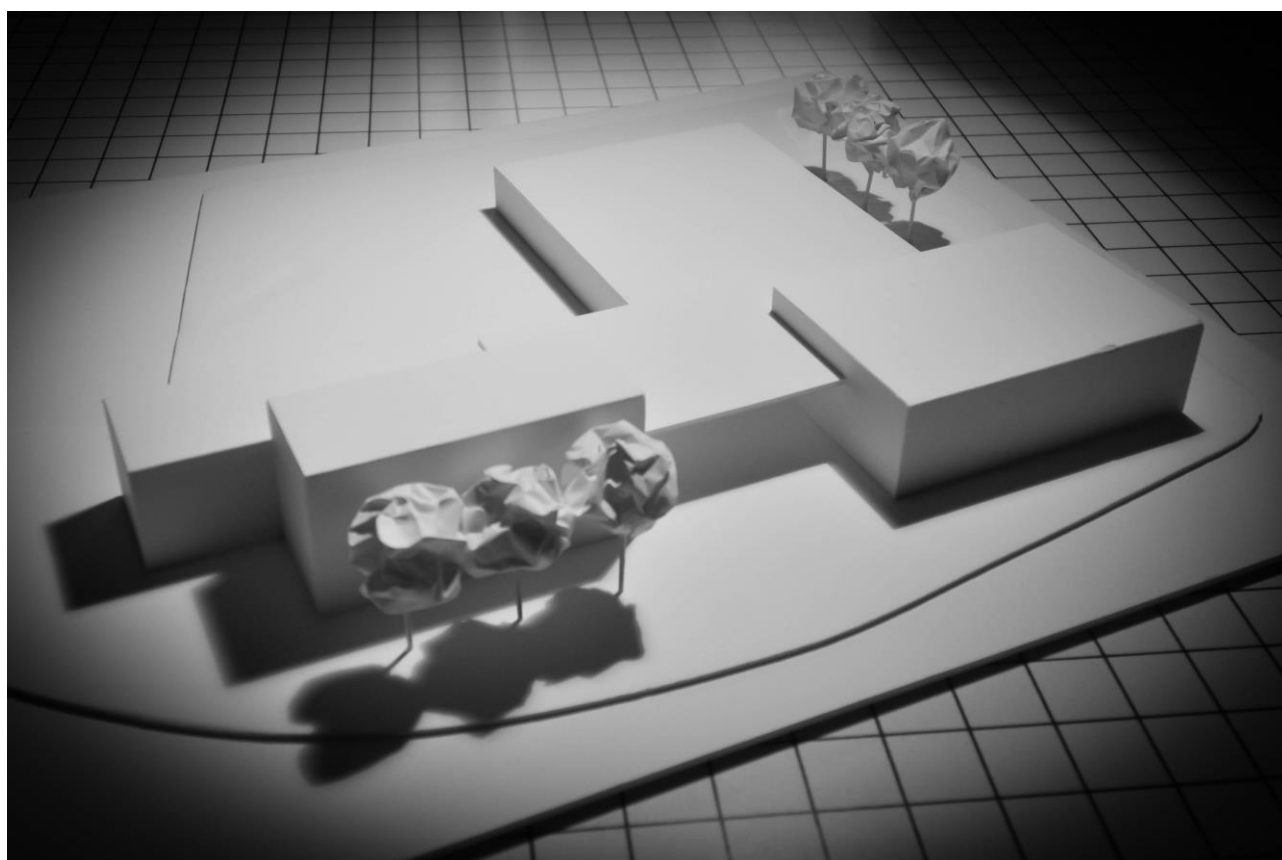

VISTA 1

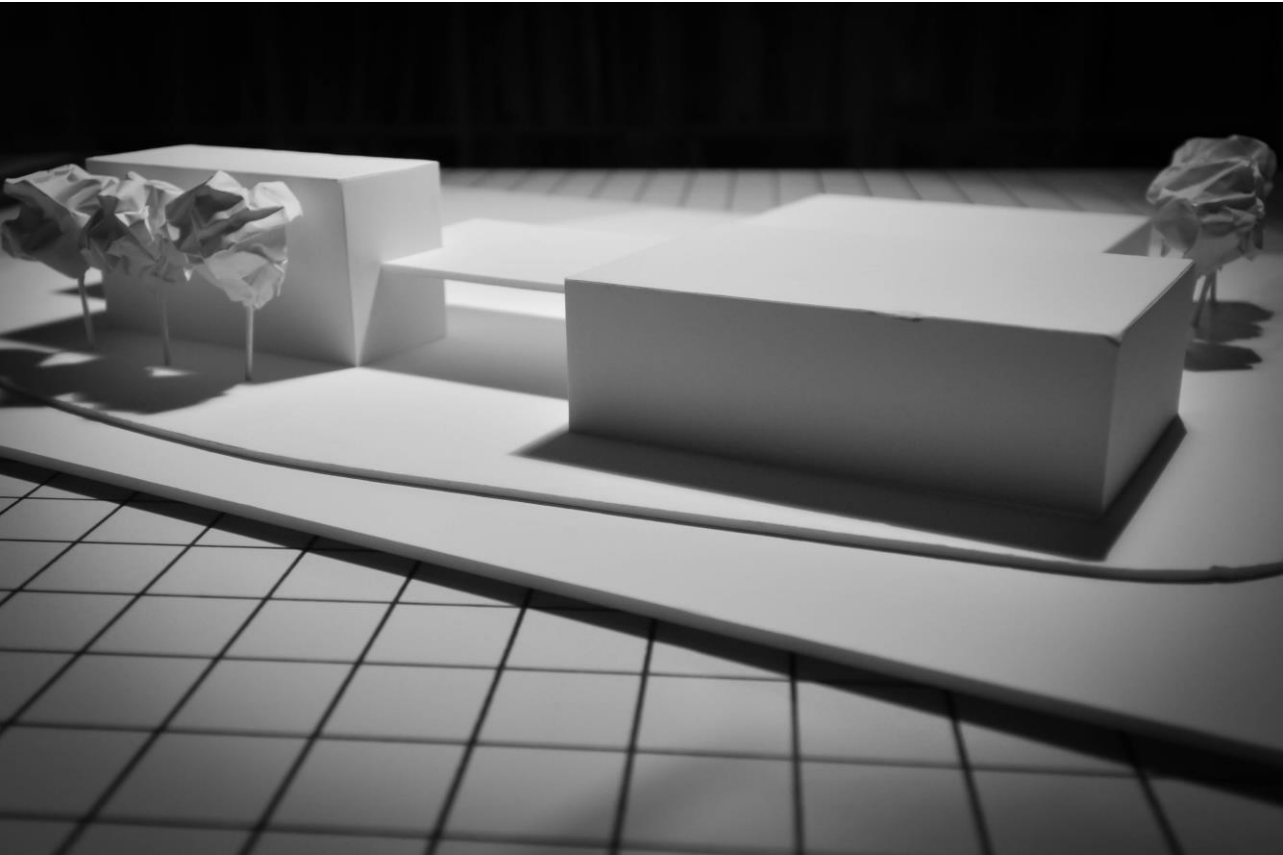

VISTA 2

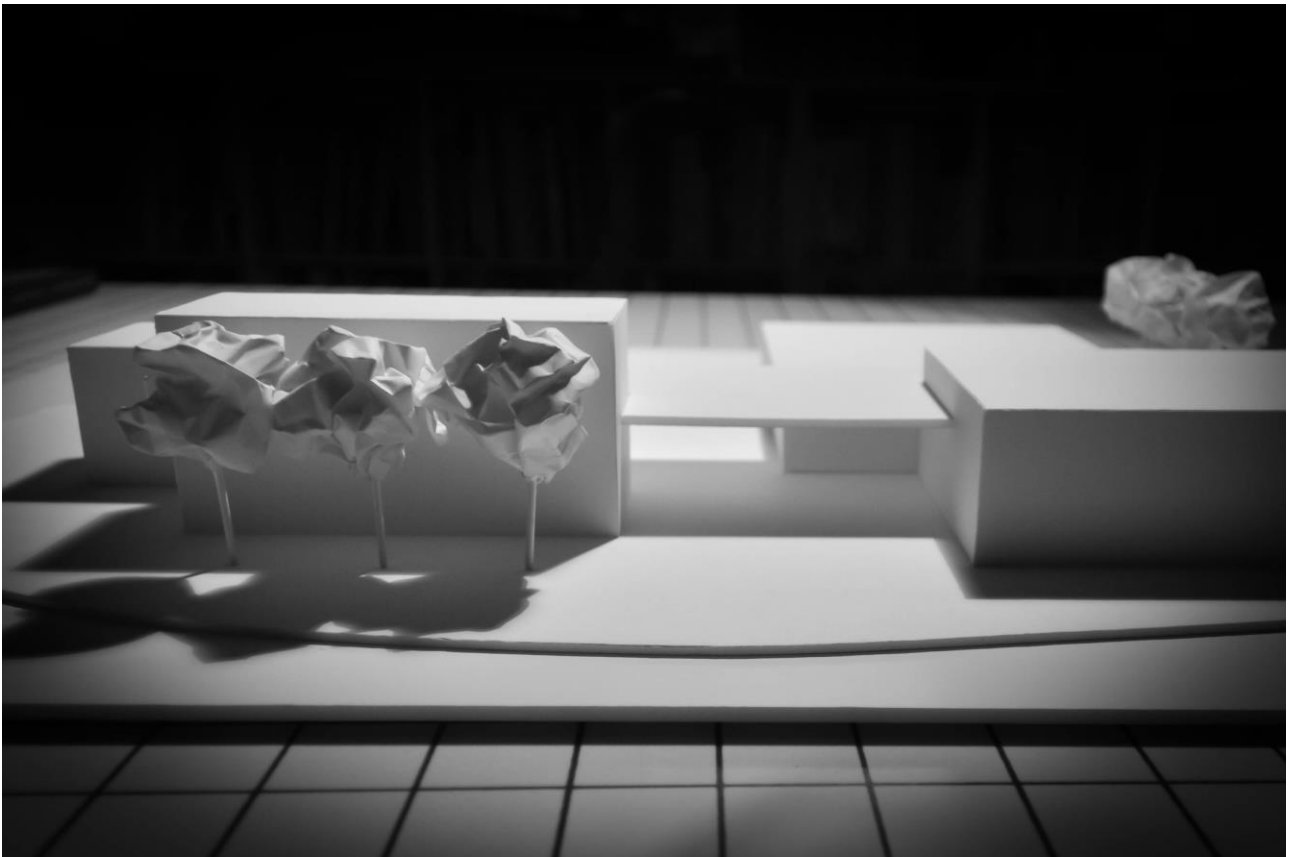

VISTA 3

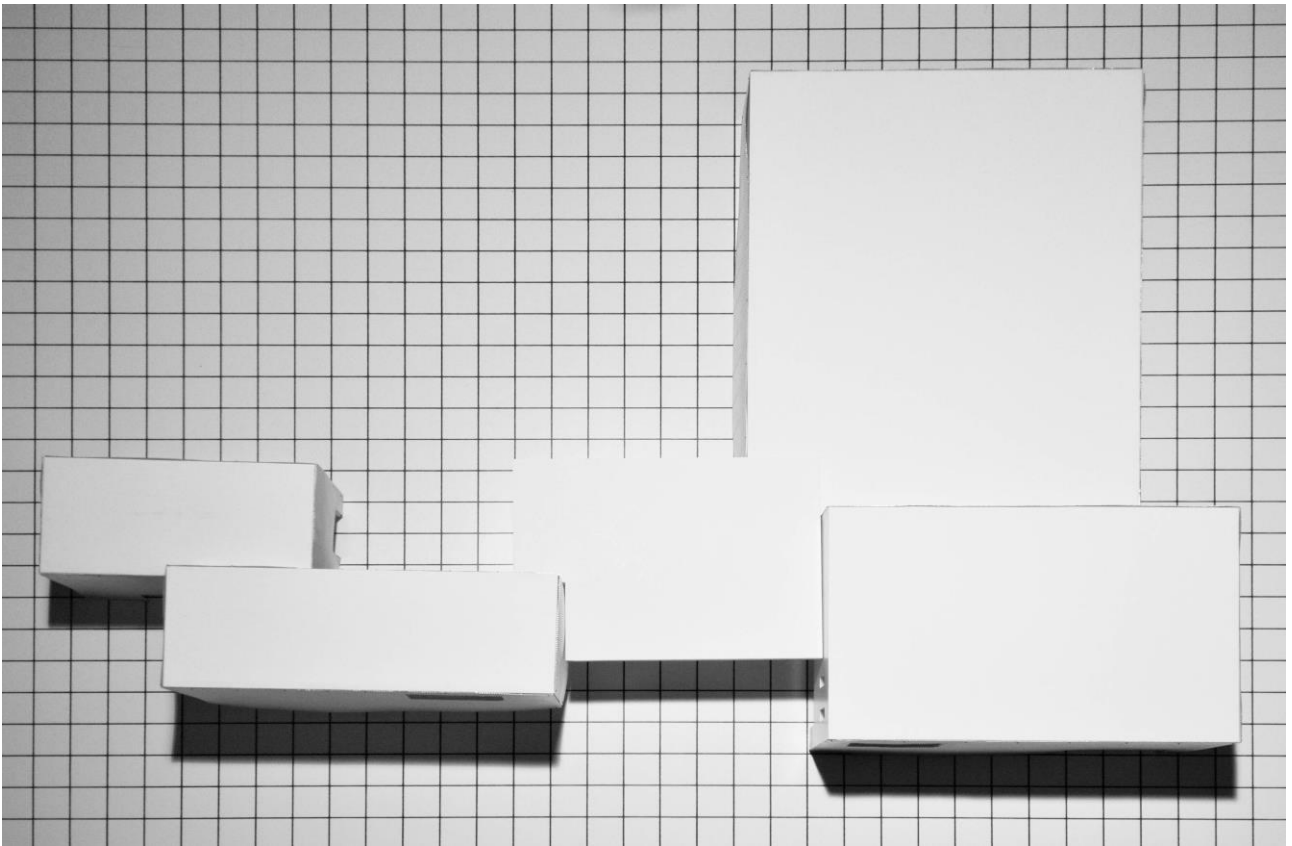

VISTA 4



VISTA 5

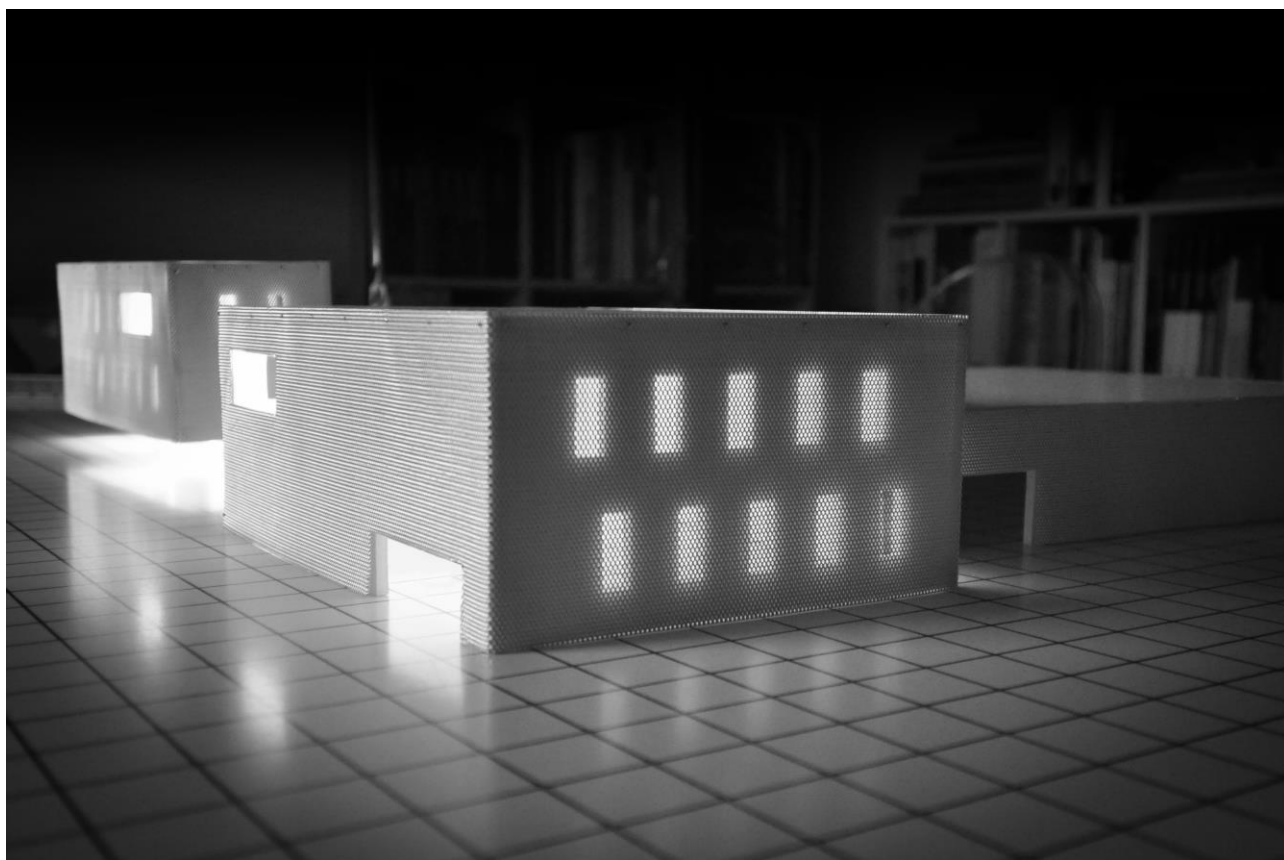

VISTA 6